



INSTALLATION INSTRUCTIONS

SPEC Living
Multi Family Flooring Experts

CARPET TILE INSTALLATION INSTRUCTIONS

Please read all instructions carefully before you begin installation. Improper installation will void warranty.

Your carpet tile must be allowed to acclimate to the environment of the installation area. Lay closed packages in a horizontal position in the room for 48 hours prior to installation. Preferable temperature should be approximately 17-23 C (62-73 F) with a relative humidity of 45-60 percent. Humidity should never be allowed to drop below 30% as this may cause gapping.

It is the purchaser's responsibly to check the color/dye lot, pattern and quality before installation. If not satisfied with our flooring prior to installation - do not install flooring. We are not responsible for any costs associated with repairing or replacing flooring that was installed with evident defects.

TOOLS AND SUPPLIES

Double-sided carpet tape, carpet utility knife with blades, carpenters square, pencil, chalk line, and tape measure.

SUITABLE TYPES OF SUBFLOOR

Carpet tiles are not intended for installation on walls. You can install carpet tile over existing residential flooring that are wax free, such as hardwood, vinyl tile, vinyl plank or laminate. The underfloor or subfloor must be thoroughly even, dry, clean and solid. Remove any carpet staples or glue residue and make sure floor is clean for proper installation. **See diagram 1.**

If installing on a concrete floor, allow for a full 60 days before installation for the concrete to set completely, provided atmospheric conditions are dry during the curing phase. Make sure concrete has been sealed with a water based concrete sealer as per the manufacturer's instructions. Failure to properly seal a concrete floor prior to installation can cause the backing of the carpet tile to react with the floor. This can result in indoor air quality issues, and/or adherence problems.

Do not install carpet floor tiles on an unfinished, waxed wood floor or floor with vintage varnish as it may cause some discoloration or staining. Note: Sunlight could cause discoloration to your exposed floor while the floor directly under you carpet floor tiles will remain protection from the sun's fading.

This product is not suitable for damp rooms such as bathrooms, saunas, rooms with damp concrete, rooms with floor drains or rooms that could potentially flood or over surfaces where moisture could accumulate. Floor must be carefully checked for moisture problems. Any moisture problems need to be solved before installation.

WARNING: DO NOT REMOVE OLD RESILIENT FLOORING. THESE PRODUCTS MAY CONTAIN EITHER ASBESTOS FIBERS OR CRYSTALLINE SILICA, WHICH CAN BE HARMFUL TO YOUR HEALTH.

BASIC INSTALLATION

Start by determining the pattern you want to create. Refer to the arrows on the back of the carpet floor tile to ensure the tiles are going in the right direction for a straight installation. If you want to create a checkerboard effect, turn every other tile 90 degrees. **See diagrams below.**

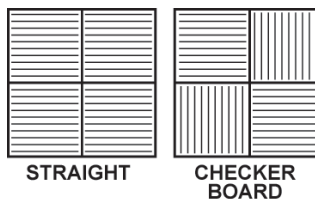

Measure the length of one wall, divide total by two and mark the center of the wall. Repeat on other walls. Use a chalk line to snap a centerline from one wall to the opposite wall. Repeat on other walls to find the center of your room and baseline

for your starting tiles. **See diagram 2.**

Without applying the double-sided carpet tape, begin laying the tiles along the baseline to determine the pattern of the tiles. Remember to line up the arrows on the back of the tile to make sure you have the desired pattern. **See diagram 3.**

Tiles that meet the wall should be at least half a full tile in width. If the tiles that meet the wall are less then half a full tile, adjust the center point accordingly. The tiles that meet the wall should be equally sized on the opposite sides of the room. **See diagram 4.**

Once you are satisfied with position of the baseline rows, you can begin installation. Apply double-sided carpet tape to the corners of your center point tile. Fit to the subfloor and press firmly to ensure the tile is stuck down. Continue applying double-sided carpet tape and sticking down the tiles ensuring that there is a snug fit between the tiles along the baseline. **See diagram 5.**

See diagram 5.

To fit the tiles next to the wall, place a tile upside down with the arrows facing up. Use a carpenter square and cut off excess with a utility knife. Ensure that the blade of the knife is sharp to get a clean cut. Apply tape and stick tile down. **See diagram 6/7.**

To fit tiles around doorjamb, pipes or irregular shapes and corners, make a pattern out of heavy cardstock. Trace the pattern onto the tile and cut with a utility knife. Place tape on backside and stick tile down.

Now you can continue installing the rest of the carpet tiles. As you fill in the area with tiles, periodically apply tape throughout the flooring pattern to further secure tile positioning. **See diagram 8/9.**

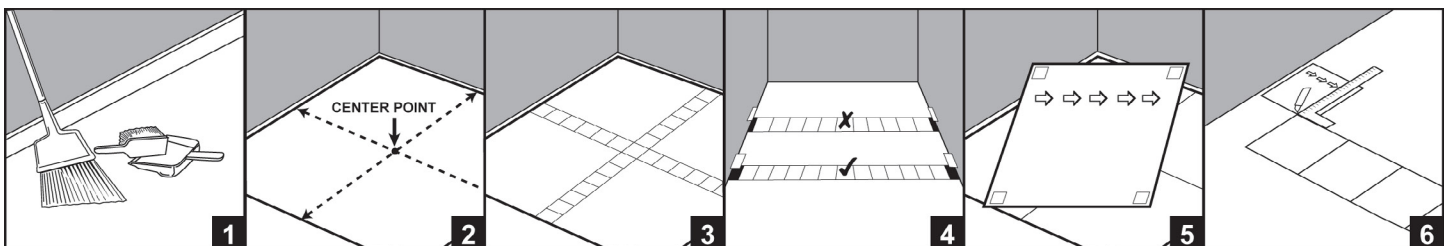



INSTALLATION INSTRUCTIONS

SPEC Living
Multi Family Flooring Experts

Once installation is completed, vacuum the entire area. The seams between the carpet tiles will blend together over time, providing the carpet tiles are properly and firmly installed.

CREATE AN AREA RUG

Determine where you want to put the area rug. It is helpful to align the area rug to the walls or furniture. *See diagram 10.*

Position the tiles to create the edge of the rug using a carpenter square. This will ensure the tiles are aligned perpendicular. Adhere tiles to the floor as you go along. *See diagram 11.*

Once the edge is complete, begin filling in the center of the area rug. Ensure the tiles fit snugly together. There is no need to apply tape to the inside, unless needed. *See diagram 12.*

MAINTENANCE AND CLEANING

To maintain your carpet tiles, vacuum regularly to remove excess dirt and grit. This will enhance the appearance of your carpet tiles.

For spills or stains, simply remove the tile and spot clean with water. Gently rinse and dry completely. Replace tile once dry. If stain is not removable, replace tile.

It's a good idea to save a few carpet tiles in case of accidental damage. Tiles can be replaced at anytime.

1-YEAR RESIDENTIAL WARRANTY

Our one-year limited residential warranty for carpet tile means that for one year, from the date of purchase, your floor will be free from manufacturing defects and/or workmanship for indoor, residential installation. The carpet tile must be installed and maintained according to the installation instructions supplied with each carton.

This guarantee applies only to the original purchaser and proof of purchase is required for all claims. The guarantee is for replacement of refund of the carpet floor tile only, no labor. This warranty is pro-rated based on the amount of time the floor has been installed. If you wish to file a claim under warranty, contact the authorized dealer where the flooring was purchased.

EXCLUSIONS:

This warranty excludes defects from the following:

- Any application other than indoor residential owner occupied use.
- Snags, fuzz, shedding, piling, and/or crushing are not considered manufacturer defects.
- Problems or damage caused by improper installation, re-installation, or improper conditions for installation.
- Mold, mildew, moisture and alkalinity damage from subfloors or flooding.
- Problems or damage due to spills, flooding, use of improper cleaning agents or maintenance methods including, but not limited to: cuts, tears, stains, burns, pets, appliances, leveling compound, indentation and/or discoloration from floor care products.
- Color differences between tiles or slight off registration of tile patterns/edges.
- Deterioration attributable to normal wear and tear.
- Labor costs including, without restriction, cost of initial installation, cost of removal and/or cost of replacement of defective tiles.

